

XTRONS

Android Car Roof Monitor

USER MANUAL

Thank you for buying this XTRONS product. Please read through these instructions thoroughly to understand how to operate this product properly. After you have finished reading the instructions, please keep this document in a safe place for future reference.

NOTICE OF INTENDED USE

Our products are designed to enable viewing of video ONLY for rear-seat occupants, and are not intended for viewing by the driver when the vehicle is in motion. Such use might distract the driver or interfere with the driver's safe operation of the vehicle, and thus result in serious injury or death. Such use might also violate state or local laws.

Manufacturer disclaims any liability for any bodily injury or property damage that might result from any improper or unintended use.

NOTE: Features and specifications listed in this manual are subject to change without notice.

Contents

Precautions	2
Important Safety Information	3
Android Car Roof Monitor	3
Remote Control	4
Hearing Safety	4
Installation Instructions	5
For Cars With a Sunroof	5
For Cars Without a Sunroof	6
Installation Kit	7
Product & Packaging	8
What's in the Box	8
Android Car Roof Monitor	8
Remote Control	10
Getting Started	13
Wiring Diagram	13
Installing Mounting Bracket	13
Installing Android Car Roof Monitor	14
In-Car Use	15
System Language Setting	15
Maintenance of the Player	16
Playback	17
Playing from USB Device	17
Listening to FM Radio Over the Vehicle's Speakers	17
Listening Over the Built-in Speakers	19
Using External IR Headset	19
Using AV input & Output	19
Using HDMI Source	20
Using Wireless Display	20
Using Bluetooth	21
Settings	22
Troubleshooting	28

Precautions

Certain country and government laws may prohibit or restrict the placement and use of this product in your vehicle. Please comply with all applicable laws and regulations regarding the use, installation and operation of this product.



If you want to dispose of this product, do not mix it with general household waste. To protect the environment and human health, please follow local laws and regulations on the disposal of electronic components or batteries.

Before installing this product

- Use this unit with a 12-volt battery and negative grounding only. Failure to do so may result in a fire or malfunction.
- To avoid shorts in the electrical system, be sure to disconnect the (-) battery cable before installation.
- Do not install this product in a vehicle that does not have an ACC wire or circuitry available.

Important Safety Information

Please read through these instructions so you will know how to operate this product properly. After you have finished reading the instructions, keep this document in a safe place for future reference.

Android Car Roof Monitor

1. Do not attempt to install or service this product by yourself. Installation or servicing of this product by persons without training and experience in electronic equipment and automotive accessories may be dangerous and could expose you to the risk of electric shock, injury or other hazards.
2. Do not allow this product to come into contact with liquids. Electrical shock could result. Also, damage to the product, smoke and overheating could result from contact with liquids.
3. If liquid or foreign matter should get inside this product, park your vehicle in a safe place, turn the ignition switch off (ACC OFF) immediately and consult your dealer. Do not use this product in this condition because doing so may result in a fire, electric shock, or other failure
4. If you notice smoke, a strange noise or odour from this product, or any other abnormal sign on the screen, turn off the power immediately and consult your dealer. Using this product in this condition may result in permanent damage to the system.
5. Do not disassemble or modify this product, as there are high-voltage components inside which may cause an electric shock. Be sure to consult your dealer for internal inspection, adjustments or repairs.
6. For children under 12 years old, please use the player under adult supervision.

Important Safety Information

Remote Control

The remote control requires two AAA batteries. Swallowing the battery may cause severe damage to your inner body or even death within 2 hours. If a battery is swallowed, please seek medical care immediately. Please keep the batteries out of the reach of children. To Avoid Battery Exhaustion, be sure to run the vehicle engine while using this product. Using this product without running the engine can drain the battery.

Hearing Safety

Listen at Medium Volume:

Please adjust the volume to an appropriate level. If the volume is too high, it may damage your hearing or even cause permanent damage.

Setting A Safe Volume Level:

1. Set the volume to a low level.
2. Increasing the volume slowly, until a comfortable, clear sound can be heard.

Listen to the Radio within A Reasonable Time Frame:

Listening for long periods, even at a reasonable volume, may cause damage to your hearing. Please use the product properly and get a rest when necessary.

Installation instructions

For Cars With a Sunroof

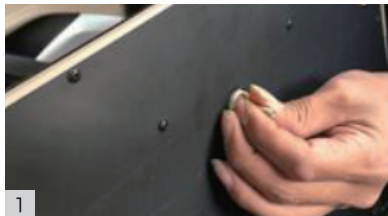

1 Separate the stand from the main unit by removing the 4 screws.



2 Mark the position of the unit in the middle, insert the metal plate into the sunroof, then tighten the screws to stabilise it.

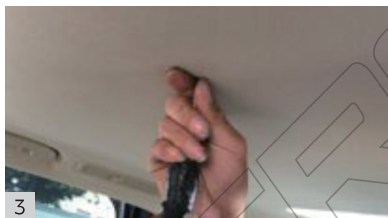

3 Use a screwdriver to mark the mounting holes.

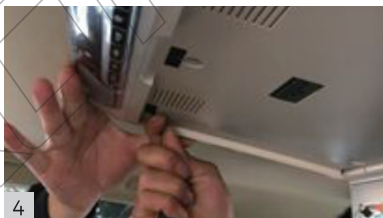

4 Install the unit with screws.

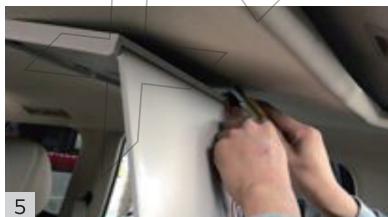

5 Cut the marked hole and insert the wires into it from the unit.



6 Fully pull the power cables out.

Installation instructions



7 Pull the wires to the A pillar and hide them.



8 Connect the power cables, ACC and ground the black cable. Now all the wires are fully hidden.

For Cars Without a Sunroof

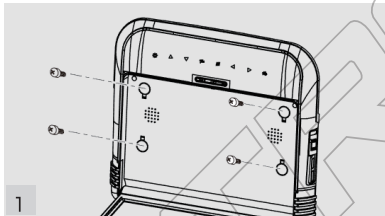

1 Separate the stand from the main unit by removing by the 4 screws.

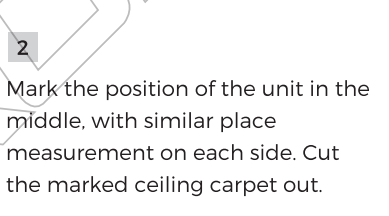

2 Mark the position of the unit in the middle, with similar place measurement on each side. Cut the marked ceiling carpet out.

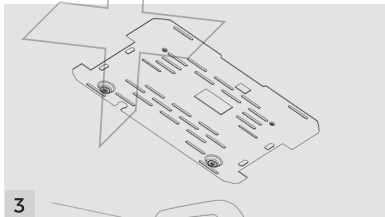

3 Locate the elongated holes on the stand in the same place, with the mounting holes on both sides.

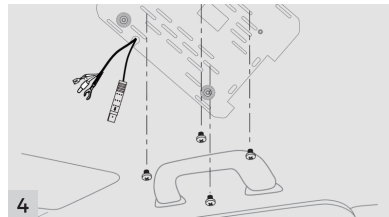

4 Choose a suitable size of screw to install the stand. Before tightening in place, pull the wire rod of the wire hole out.

Installation instructions

Installation Kit

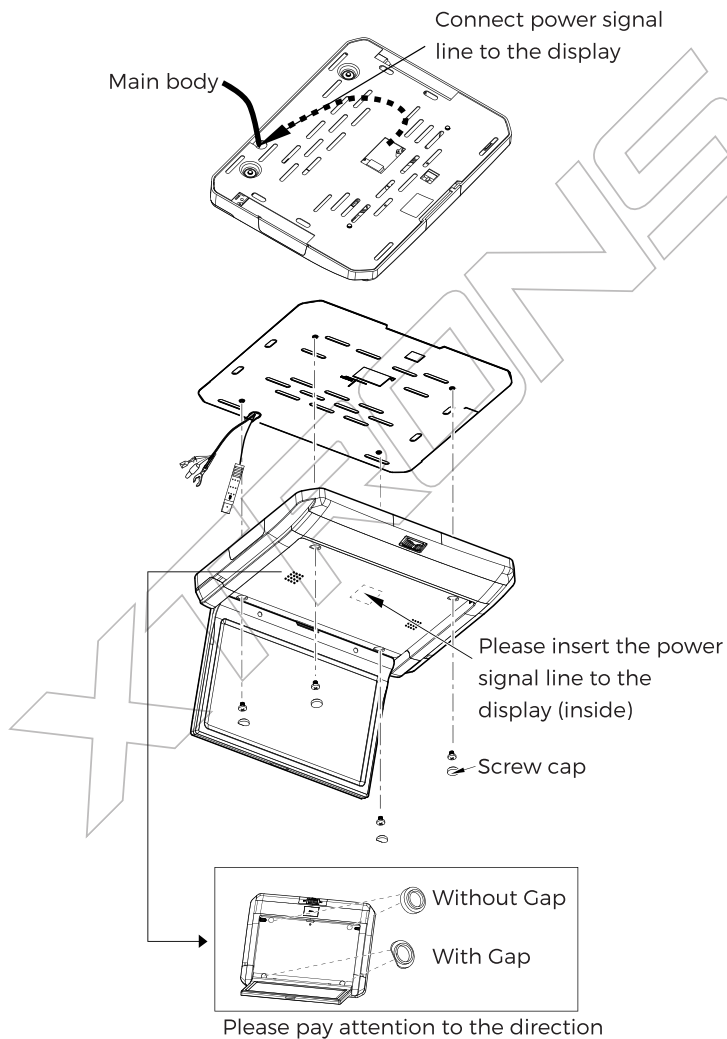

Product & Packaging

What's in the Box

1* Android Car Roof Monitor	1* Remote Control
1* ISO Wiring Harness	Several Screws (depends on model)

Android Car Roof Monitor



1. Back/Power

Touch to return to the previous screen.
Touch and hold to turn off the power.

2. LED lamp switch

Touch to switch the LED atmosphere lamp color.

Product & Packaging

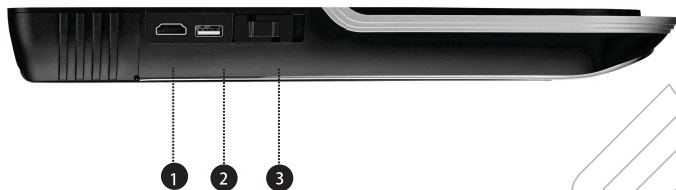

1. HDMI port

Connect a device to the product using an optional HDMI cable or adapter.

2. USB port

Plug a USB storage device into the USB port.







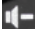
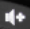

3. Light switch

Push to turn the light on or off.

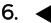
Remote Control



Functions of Remote Control

1.  Press to turn the power on or off.
2.  Press to turn the volume down.
3.  Press to turn the volume up.
4.  Press to move upwards when navigating through the menu.
5.  Press to move downwards when navigating through the menu.
6.  Press to move left when navigating through the menu.
7.  Press to move right when navigating through the menu.
8.  Press to confirm.
Left mouse button.
9.  Press to display the menu.
10.  Press to return.
Right mouse button.
11.  Press to return to Homepage.

12. 

Press to turn the mouse on or off .

13. 

Press to go to previous page.

14. 

Press to go to next page.

15. 

Press to mute.

Using the remote control

Point the remote control in the direction of the front panel to operate.

- The remote control may not function properly in direct sunlight.
- Do not store the remote control in high temperatures or in direct sunlight.
- Do not let the remote control fall onto the floor, where it may become jammed under the brake or accelerator pedal.

Replacing Remote Control Battery

1. Open the remote control back cover.
2. Check for correct battery polarity when installing the battery.
3. Insert two AAA model batteries and close the back cover.
4. When not using the remote control for a long period of time, please remove the batteries and store them separately.

Getting Started

Wiring Diagram

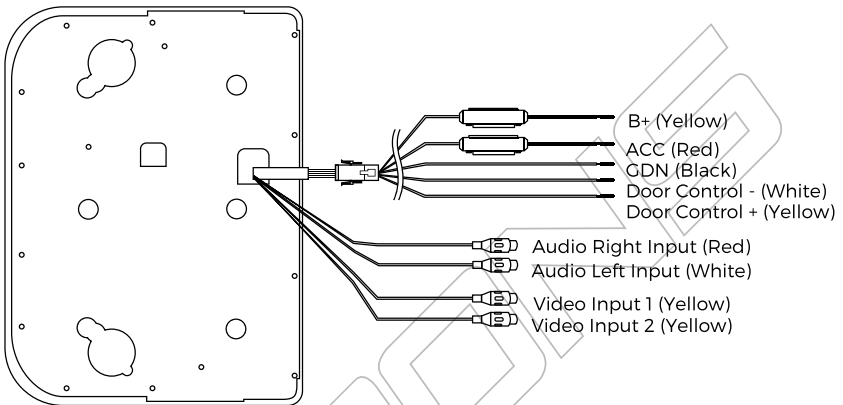

Installing Mounting Bracket

1. Once all the pre-wiring is complete, please find the mounting bracket and screws.
2. Carefully align the mounting bracket in the location it is to be installed with the direction arrow facing the front of the vehicle (make sure there is nothing between the mounting bracket and the roof support).

NOTE: The headliner may need to be cut to install the bracket. When cutting the headliner, make sure no wires above the headliner are cut.

3. While holding the mounting bracket in place, install screws.

CAUTION: Be sure that the screws do not pierce the outer roof skin when fully fastened to the roof support.

Getting Started

Installing Android Car Roof Monitor

1. Make all electrical connections.
2. Attach the monitor to the mounting bracket using screws.

CAUTION: Do not trap any bulk wiring or other accessories such as filters between the supplied bracket and the unit. Any such items can block air flow in addition to placing pressure on the top of the unit which could lead to performance issues.

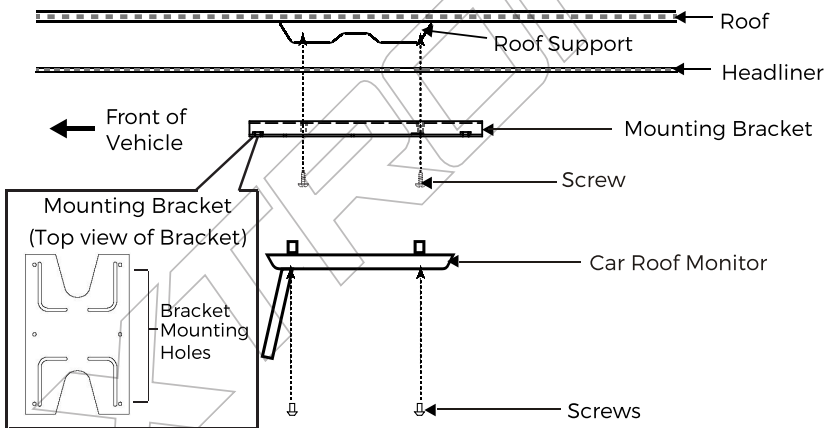

CAUTION: Use extreme caution when using the Screws to avoid damage to vehicle roof or other components, wiring, etc.

WARNING: Any use of a mounting substrate other than the supplied bracket may result in performance issues. The supplied bracket was designed to ensure this Mobile Video System is properly installed without adding any strain or stress to the system which could result in operation problems.

Getting started

In-Car Use

Notice: Due to the possible high temperature inside a closed car, please remove the machine and store in a cool ventilated place if it's not used for a long time.

1. First, turn off the vehicle ignition and connect the supplied car charger to the vehicle's power outlet socket.
2. Connect the other end of the charger cable to the DC power input on the side of the player.
3. Then turn the vehicle ignition switch to ON or ACC and turn on the player's power switch.

System Language Setting

Choose one out of several different languages as the OSD language.

1. Press "Power" button on the remote control to turn on the power.
2. Touch the "Setting" icon on the main screen or press the "Mouse" button on the remote control to open the Mouse, point at "Settings", press the "OK" button > "System" > "Language & input" > "Language" > slide to select the desired OSD language.
3. Touch "◀" on the player or press "Return" button on the remote control to return to the previous menu, touch or press again to exit the Setup Menu.

Getting started

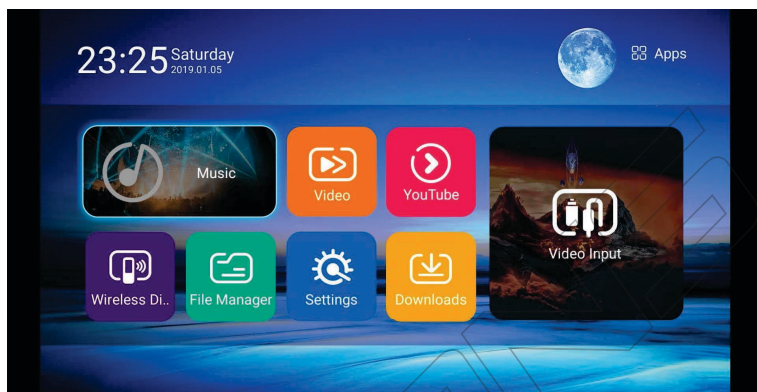

Maintenance of the Player

1. The player's working temperature: 5-40°C.
2. Please do not unplug power cable when it's in use.
3. It's normal that the player generates heat when playing video, but please do not overuse the player or this may become an issue.
4. Please unplug the power cable during electrical or thunderstorms or when the player is not being used for a long period of time.
5. Please do not use or store the player in a very hot, very humid or very cold environment
6. Please place the player in a cool, dry and well ventilated place when it is not in use; please do not cover the player with cloth or other object that could impair the efficiency of cooling.
7. Please make sure the player is powered off before cleaning.
8. Do not use any chemicals or cleaning agents to clean the machine, gently wipe the outside of the machine with a clean cloth.

Playback

Playing from USB device

Plug in a USB storage device and then tap "Music" icon on the main interface or "Music Player" on the apps menu to play music. Tap Video icon on the main interface or "Movie" on the apps menu to play video files. Tap "Picture Viewer" on the apps menu to view images and photos.

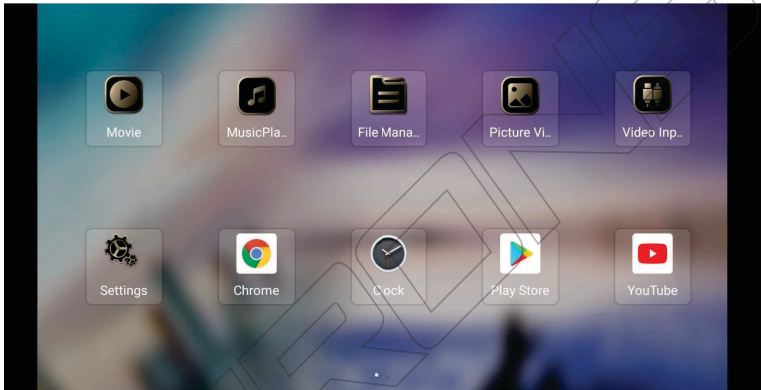

Note:

1. USB device can read FAT32 format file. Max capacity of the USB device shall not be over 128GB.
2. USB device maximum support 8K video decoding and playback.
3. Before removing the USB storage device, stop playback first.

Listening to FM Radio Over the Vehicle's Speakers

The product uses a wireless FM transmitter to send audio through the vehicle's speakers.

Playback



To listen to FM over your speakers:

1. Make sure mute is off. Please go to "Settings" > "Quick Settings" > "FM", or swipe up on the home screen, tap "⚙️" then choose "FM", otherwise no sound will come out. Select FM mode on the screen, and then select a FM frequency as described below.
2. Turn on the car radio. Turn to the FM frequency display on the screen, such as FM 88.1.
3. If no audio is heard, try changing the FM transmitter frequency and re-tuning the radio to a new frequency.

The product saves the frequency you select, and returns back each time the product is turned on. You may want to store the FM transmitter frequency as a preset of your radio for ease of use.

Note: You might still experience interference if a powerful station is using a frequency that's nearby, or you are hearing a radio station mixed in with the system audio. To avoid this type of interference, try to find an empty space on the dial that has neighboring stations that are at least 0.2 MHz above and below. Do not use local radio stations' frequencies.

Listening Over the Built-in Speakers

You can listen over the built-in speaker. Please make sure mute is off and set the volume to a low level.

To listen over the built-in speaker, make sure mute is off. Please go to "Settings" > "Quick Settings" > "Speaker", or swipe up on the home screen, tap  then choose "Speaker", otherwise no sound will come out.

Using External IR Headset

A separately sold wireless IR headset is required for utilising the IR transmitter function.

A dual channel wireless IR headset has a two-position slide switch labeled "A/B". When the switch is in the "A" position, the headset plays audio from the source designated as "IR A". When the switch is in the "B" position, the headset plays audio from the source designated as "IR B".

To listen over an external IR headset, make sure mute is off. Please go to "Settings" > "Quick Settings" > "IR", or swipe up on the home screen, tap  then choose "IR", otherwise no sound will come out.

Using AV Input & Output

An external video source, video game system, or other audio/video devices can be connected to the AV input.

The product provides an AV output for optional video monitor(s).

Connect the AV cable with the Android Car Roof Monitor, and plug the other ends into the corresponding "AV IN" ports of other monitor. Please make sure that the connectors at both ends are fully inserted and tightened.

This input & output will provide the AV signals that duplicate the picture/audio being processed by the product to an additional monitor or video display.

Using HDMI Source

Plug the HDMI cable into the Android Car Roof Monitor's "HDMI" port, and plug the other end into the corresponding "HDMI Output" port of a HDMI-enabled machine. Please make sure that the connectors at both ends are fully inserted and tightened.

You can display the video image output by the device connected to this product. An appropriate HDMI cable or adapter (sold separately) is required for connection. You can also connect other widgets such as XTRONS HDTV05 (sold separately) via HDMI which can stream contents from your mobile phones.

Using Wireless Display

Tap "Wireless Display" icon on the main interface to enter wireless display mode. Find the Miracast or Screen Mirroring on your phone, tap to open the Miracast or Screen Mirroring, the phone will automatically search for available devices, then select the SSID devices on the screen to connect. After you connect a mobile phone with compatible applications installed, you can control the applications for the mobile phone directly from this unit.

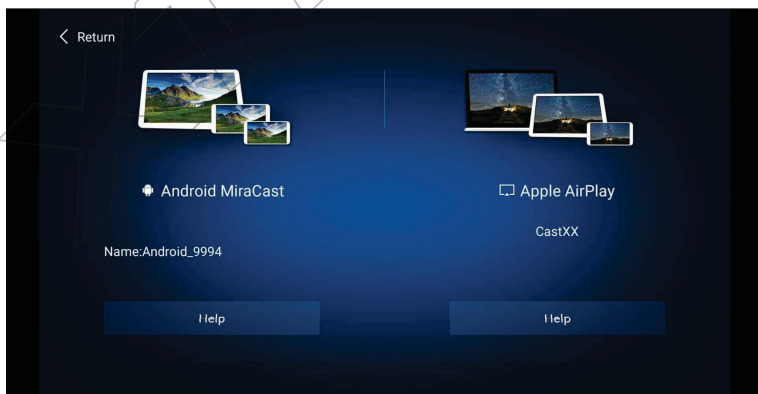

Note: Not all Smartphones are compatible with wireless display function.

Using Bluetooth

Connect your bluetooth headset or bluetooth speaker to this unit via Bluetooth to listen to Music.

Connection (Bluetooth pairing)

- A. The Bluetooth device must be within 1 metre of this unit. Turn on Bluetooth on the device and on the Android Car Roof Monitor.
- B. You can find your Bluetooth device list on the monitor. Touch to pair.
- C. If your Bluetooth device supports SSP (Secure Simple Pairing), a four-digit numerical password will be required. The default password is 0000.

Bluetooth Music

After the Bluetooth connection is established, tap "Music" icon on the main interface or "Music Player" on the apps menu, and then you can play music stored in this unit through the connected Bluetooth device.

1. Network & Internet

1.1 Wi-Fi

Turn Wi-Fi on or off.

Choose a network: Tap one of the listed networks and then enter the password if required.

1.2 Airplane Mode

Turn airplane mode on or off.

1.3 Data usage

View the data usage for your apps.

1.4 Portable Hotspot

Turn Wi-Fi hotspot on or off. Customise the Wi-Fi hotspot settings.

1.5 Mobile Plan

Insert SIM card and restart.

1.6 VPN

Tap the + button and provide the VPN's details. Tap the VPN to connect once you have set it up. You will be asked to enter a username and password.

1.7 Private DNS

Select the Private DNS mode from Off, Automatic and Private DNS provider hostname.

2. Bluetooth

2.1 Bluetooth

Turn bluetooth on or off. You can change the Device Name of this unit when bluetooth is on.

Settings

2.2 Pair new device

Bluetooth will turn on to pair.

2.3 Previously connected devices

Tap to see the previously connected devices.

3. Apps & notifications

3.1 Recently opened apps

View all the recently opened apps.

3.2 Notifications

Add or change an alert style for notifications from apps.

3.3 Default apps

Set up default apps for Assist & voice input, Browser app and Home app.

3.4 App permissions

Apps using location, microphone, camera.

3.5 Special app access

1 app can use unrestricted data.

4. Quick Settings

Set the volume, brightness and audio output channel from Speaker, FM and IR.

5. Display

Settings

5.1 Brightness level

Drag the slider to adjust the screen brightness.

5.2 Theme & Boot logo

Set the theme and boot logo. You will be asked to enter the password.

5.3 Sleep

Set the sleep time for the unit. Choose from after 15 seconds, 30 seconds, 1 minute, 2 minutes, 5 minutes, 10 minutes, 30 minutes and off.

5.4 Screen Saver

Set or change the current screen saver from photo table, clock and colours.

6. Storage

You can see how much storage space is available on the head unit's internal storage. You can tap FREE UP SPACE to delete photos, videos, and apps that you haven't used recently.

7. Security & location

7.1 Google Play Protect

Scan devices for security threats and turn harmful app detection on or off.

7.2 Find my device

You will need to add a Google account on the device first.

7.3 Privacy

- Location
- Device admin apps

8. Accounts

Add a Google account or other accounts.

9. System

9.1 Power on mode

Choose the power on mode between Power Key and ACC On.

9.2 Boot app

Set the boot app.

9.3 Delay to shutdown

Choose the shutdown time from after 30 seconds, 1 minute, 3 minutes, 5 minutes and immediately.

9.4 About device

You can see the below informations:

- Device name
- CPU
- RAM
- Flash Memory
- Model & hardware
- IMEI

- SIM status
- Android version
- IP address
- Wi-Fi MAC address
- Bluetooth address
- Build number

9.5 Languages & input

9.5.1 Languages

Set the language for the unit. Choose from English, French, German, Spanish, and many more.

9.5.2 Virtual keyboard

Choose between Android Keyboard (AOSP) and Remote controller input method. You can set and manage the installed keyboards.

9.5.3 Physical keyboard

Set up your external keyboard.

9.5.4 Advanced

- Spell checker
- Autofill service
- Personal dictionary
- Pointer speed

9.6 Date & time

- Automatic date & time
- Set date
- Set time
- Automatic time zone

- Select time zone
- Automatic 24-hour format
- Use 24-hour format

9.7 Backup

- Back up my data
- Backup account
- Automatic restore

9.8 Reset options

- Reset Wi-Fi, mobile & Bluetooth
- Reset app preferences
- Erase all data (factory reset)

XTREME

Troubleshooting

SYMPTOM:	REMEDY
No power at video monitor	<ul style="list-style-type: none"> Verify +12 VDC on the Red wire at 6 Pin Power/Dome. Light Harness behind the video monitor. Verify a ground connection with a continuity test from a known good ground to the black wire.
Power but no video or sound	<ul style="list-style-type: none"> Verify that the Source is on and playing back compatible media content.
IR Wireless Headphones do not work	<ul style="list-style-type: none"> Check if batteries are installed correctly. Make sure that the headphone batteries are fresh. Check if power button lights up when pressed. If power button does not light up when pressed, change batteries. If using Dual Channel Wireless Headphones, make sure the correct channel is selected. Make sure the IRT power is ON. Press the IRT ON/OFF button on the remote control and IRT ON or IRT OFF is displayed.
FM Transmitter does not work	<ul style="list-style-type: none"> Check that radio is ON and in FM mode. Check that radio is tuned to the same frequency as the unit is set to. Select another FM channel. Reposition the Unit's Wireless FM antenna for better reception. Optional Module FMDIRB will allow the internal FM Transmitter to become a hardwired FM modulator. This option will provide the best FM connection to the vehicle radio.
Remote Control does not work	<ul style="list-style-type: none"> Check that the battery is installed correctly. Make sure that the remote control battery is fresh. The remote control is a dual function remote control, make sure M1/M2 is selected correctly.
HDMI source does not work with a smartphone	<ul style="list-style-type: none"> A special adapter is required to connect a smartphone to the HD input. Contact the smartphone service provider for ordering information on the appropriate adapter.

For more information, please visit our websites



www.xtrons.com

For installation and technical advice, please visit



bbs.xtrons.com



Facebook

<https://www.facebook.com/Xtrons/>



Twitter

https://twitter.com/xtrons_ug



YouTube

<https://www.youtube.com/user/ourxtrons/>



RSS

<https://xtrons.com/rss/>

© XTRONS CORPORATION. All rights reserved.

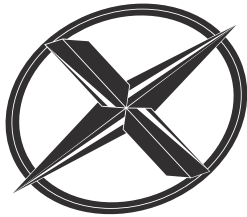

www.xtrons.com 